

Models/Modelos/Modèles  
**9190TL-▲-DST**  
 Series/Series/Seria  
**Broderick®**

**RP100845▲**

Escutcheon, Mounting Screws (2), Gasket, Nuts (2) & Washers (2) (not included)  
 Chapa, tornillos de montaje (2), empaque, tuercas (2) y arandelas (2) (no se incluyen)  
 Plaque de finition, vis de montage (2), joint, écrous (2) et rondelles (2) (non inclus)

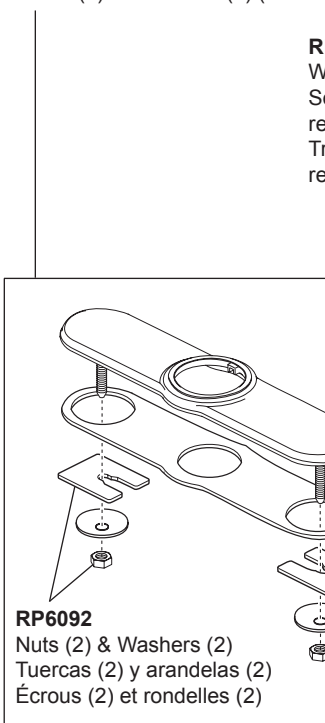

**RP6092**

Nuts (2) & Washers (2)  
 Tuercas (2) y arandelas (2)  
 Écrous (2) et rondelles (2)

**RP80977**

Wand Retainer & Replacement Kit  
 Soporte para el mango y piezas de repuesto  
 Trousse de rechange et pièce de retenue de douchette



**RP100833▲**

Sprayer Assembly  
 Ensemble de rociador  
 Pulvérisateur

**RP100832**

Gasket  
 Empaque  
 Joint

**RP80523**

Hose Weight Assembly  
 Peso de la manguera  
 Masselotte du tuyau



**RP64075**

Indicator Base Assembly  
 Ensemble de la base con indicador  
 Base à voyant indicateur

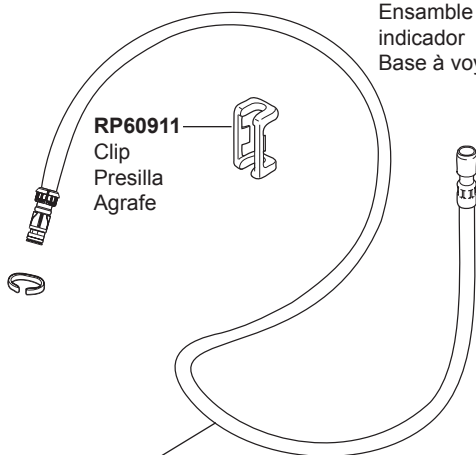

**RP80522**

Hose Assembly  
 Ensemble de la manguera  
 Tuyau souple

**RP60923**

Retainer  
 Funda  
 Douille

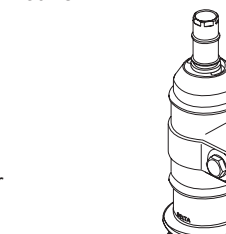

**RP91902**

Cartridge Assembly  
 Ensemble de la válvula  
 Soupape



**RP90781**

O-Ring  
 Anillo O  
 Joint toriques



**RP100836▲**

Cap  
 Bonete  
 Chapeau

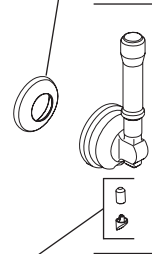

**RP78741**

Contact Spring  
 Resorte de contacto  
 Ressort de contact

**RP74776**  
 Bonnet Nut  
 Tuerca  
 Écrou

**RP100835▲**

Set Screw & Button  
 Tornillo de ajuste y botón  
 Vis de calage et bouton

**RP100834▲**

Handle, Set Screw & Button  
 Manija, tornillo de presión y botón  
 Poignée, vis de calage et bouton

**RP13938**

O-Rings (2)  
 Anillos "O" (2)  
 Joints torique (2)

**RP51243**

Inlet Gaskets  
 Empaques para el tubo de entrada  
 Joints côté alimentation

**RP92714**

Mounting Bracket Assembly, Nut & Wrench  
 Ensemble del soporte de montaje, la tuerca y la llave de tuercas  
 Fixation de montage, écrou et clé

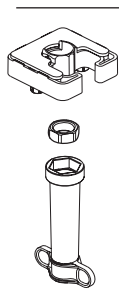

▲Specify Finish/Especifíque el acabado/Précisez le fini

**EP102240**  
Solenoid Assembly  
Ensamble de solenoide  
Electrovanne

For CZ, PC, SS, PN, AR & KS finishes, order **EP102240**  
For BL, MW, RB & SP finishes, order **EP102240XX**

Para acabados CZ, PC, SS, PN, AR y KS, ordene **EP102240**  
Para acabados BL, MW, RB y SP, ordene **EP102240XX**

Pour les finis CZ, PC, SS, PN, AR et KS, commandez **EP102240**  
Pour les finis BL, MW, RB et SP, commandez **EP102240XX**

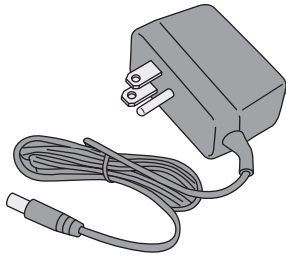

**EP102157**  
9 Volt Power Supply  
(Accessory Order Only)  
Fuente de alimentación de 9 voltios  
(Orden de accesorios solamente)  
Alimentation électrique 9 volts  
(L'accessoire seulement)

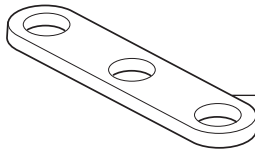

**RP37490**  
Thin Deck Aid (Not Included)  
Soporte para encimera delgada  
(No incluido)  
Plaque de renfort (non incluse)



**RP83779**  
Pump  
Bomba  
Pompe

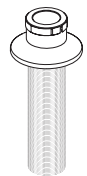

**RP100632▲**  
Dispenser Assembly  
(Not included)  
Ensamble del dispensador (no se incluyen)  
Distributeur (non inclus)

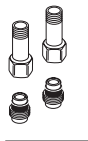

**RP53468**  
Check Valves  
Válvulas  
Checadoras  
Clapets de non-retour



**RP93410**  
Filter  
Filtro  
Filtre

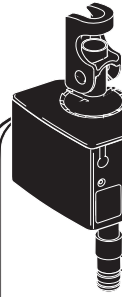

**RP13938**  
O-Ring (2)  
Anillo "O" (2)  
Joint torique (2)



**RP60911**  
Clip  
Presilla  
Agrafe



**RP78389**  
Battery Box  
Caja de la batería  
Boîtier de piles

Other useful accessories that may be purchased separately.  
Otros accesorios útiles que se pueden comprar por separado.  
Autres accessoires utiles pouvant être achetés séparément.

**RP63263**  
Adapters  
3/8"-24 UNEF to 1/2"-20 UN &  
3/8"-24 UNEF to 1/2"-14 NPSM  
Adaptadors  
3/8"-24 UNEF a 1/2"-20 UN &  
3/8"-24 UNEF a 1/2"-14 NPSM  
Adaptateurs  
3/8 po-24 UNEF à 1/2 po-20 UN et  
3/8 po-24 UNEF à 1/2 po-14 NPSM

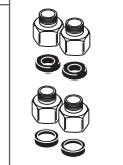

**RP63264**  
Adapters (10) 3/8"-24 UNEF to 1/2"-20 UN  
Adaptadors (10) 3/8"-24 UNEF a 1/2"-20 UN  
Adaptateurs (10) 3/8 po-24 UNEF à 1/2 po-20 UN



**RP63265**  
Adapters (10) 3/8"-24 UNEF to 1/2"-14 NPSM  
Adaptadors (10) 3/8"-24 UNEF a 1/2"-14 NPSM  
Adaptateurs (10) 3/8 po-24 UNEF à 1/2 po-14 NPSM

